

MEDIUM PEDESTAL SLIDE 6050-061
20.5 SQ METRES 70mm WETPOUR SURFACING
18.0 LINEAR METRES WETPOUR EDGING
21 GRASS MATS
MAX FFH = 1625mm

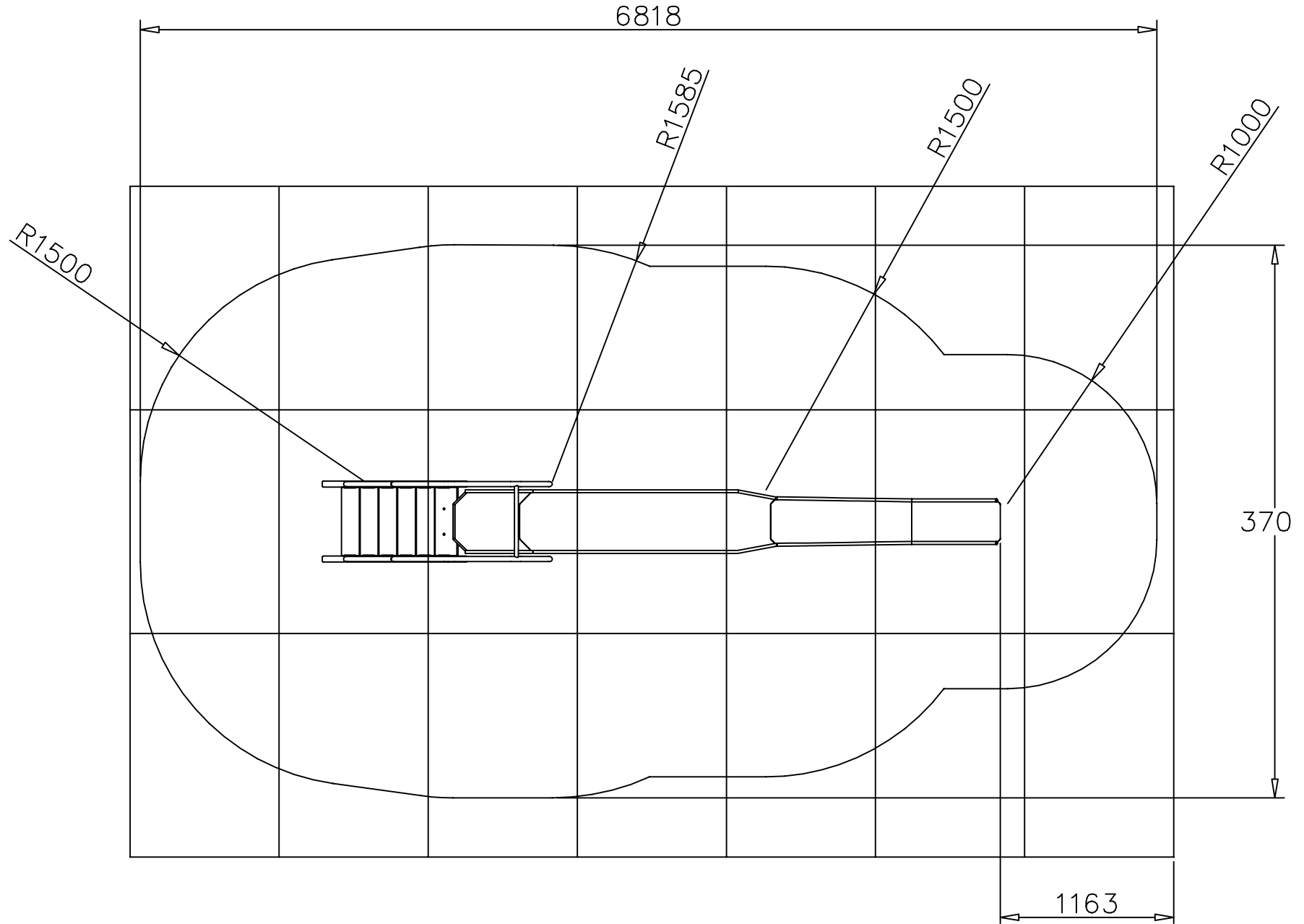

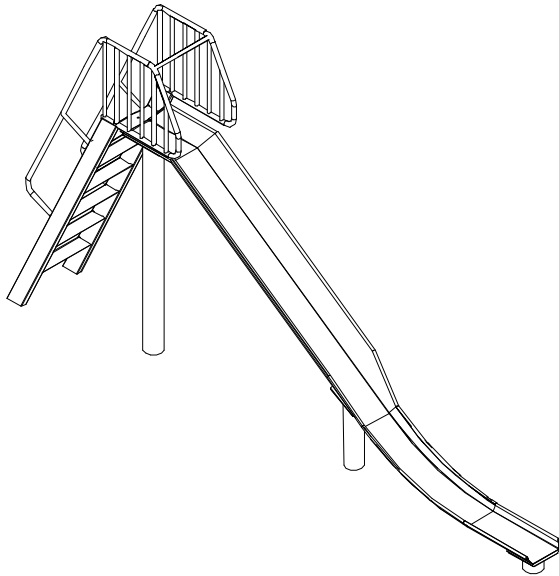

SLIDEPLAY	
MEDIUM PEDESTAL SLIDE	
PROD CODE:	6050-061
SIZE:	4.43m x 0.54m x 2.44m
AGE RANGE:	7—10 years
FREE FALL HEIGHT:	1620mm
FREE SPACE:	1000mm rad. at CL.
WEIGHT OF HEAVI-EST PART	58 Kg
OVERALL WEIGHT OF UNIT	240 Kg

DELIVERY LIST		
Part No.	Description	Qty
5031-410	Chute Assembly	1
5051-026	Medium Ladder Assembly	1
4013-035	Support Tube-Medium Slide	1
4013-037	Support Tube-Middle	1
4013-038	Support Tube- Runout	1
3030-009	Spragging Iron	4
	Fixings Pack	

SPECIFICATION

Slide chute made from 14 gauge stainless steel sheet to BS 1449 Pt 2 (1983) and welded in one section. Solid steel components made from steel to BS 9070 Part 1 (1983). Steps made from steel Durbar Chequer Plate. Standard fastenings are plated and made to one of the following specifications:-BS 3692 (1967);BS 4190 (1967);BS 4168 Part 1 (1981);BS 4174 (1972). Non standard fastenings are plated for weather protection and designed to deter vandals. Metal parts coated with low lead polyester powder paint to BS EN71 part 3 (1995)

Note :- In accordance with 6.1.3 EN1176-1:2008 we recommend that slides do not face south or near due south due to heat build up.

INSTALLATION INSTRUCTIONS

1. Read installation instructions thoroughly before commencing erection of unit.
2. Before erection ensure that slide is orientated away from the sun to prevent chute from becoming too hot.
3. Do not tighten fastenings until instructed to do so.
4. Excavate foundations as shown on foundation plan.
5. Place Medium slide support tube (D) on its side.
6. Fit chute assembly (A) to support fixing plate (D) with M10 x 30 Pent Button Head Screw (M), 10mm fibre washer (N), M10 Nyloc nut (U) and M10 Nut cover (V). Ensure that 2 off 10mm fibre washers (N) sit between the support fixing plate and the chute.
7. Fit middle support tube (E) and runout support tube (F) to slide chute assembly using M12 x 25 Pent Button Head Screw (L) and 12mm fibre washer (S). Ensure fibre washer sits between support tube plate and chute.
8. Fit spragging irons (G) in all support tubes.
9. Lift this assembly into prepared foundations so that support tubes rest on 75mm bricks and prop up securely
10. Position medium ladder assembly (B) into foundation holes and secure top step to support tube fixing plate with M10 x 30 Pent Button Head Screw (M), 10mm fibre washer (N), M10 Nyloc nut (U) and M10 Nut cover (V). Ensure that 2 off 10mm fibre washers (N) sit between top step and support tube plate.
11. Check slide for overall height, runout height, that it is plumb and square, then fully tighten all fastenings. Ensure that runout slopes down by approx 2 degrees to allow water to run off.
12. Backfill foundations with concrete. Concrete mix to be 4 parts gravel, 2 parts sand, 1 part cement. Amount of concrete required is 0.92 cubic metres.
13. Prevent use of equipment until concrete has fully set, approx. 96 hours.
14. Amount of concrete required for bark fixed slide is 0.69 cubic metres.
15. When foundations have fully set, re-tighten all fixings and backfill with bark particles to a depth of 300mm.



Note:-Ensure all installation aids are removed before first use.

Note: All protruding screw threads to be peened over to remove sharp edges.
Lifting aid will be required when installing this piece of equipment.

SURFACING & FREE SPACE DETAIL

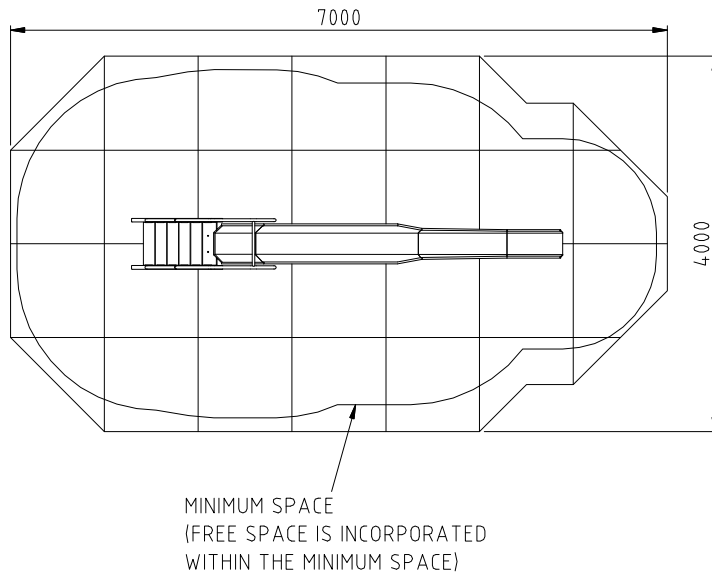

FOUNDATION DETAIL

(Care must be taken under abnormal conditions)

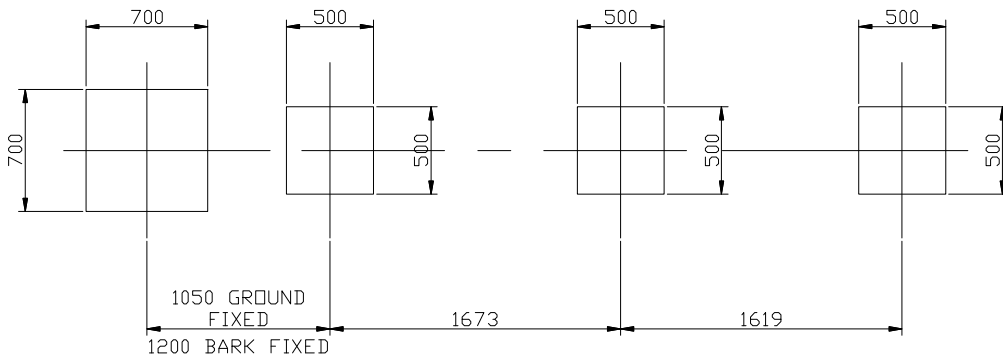

Ground Fixed

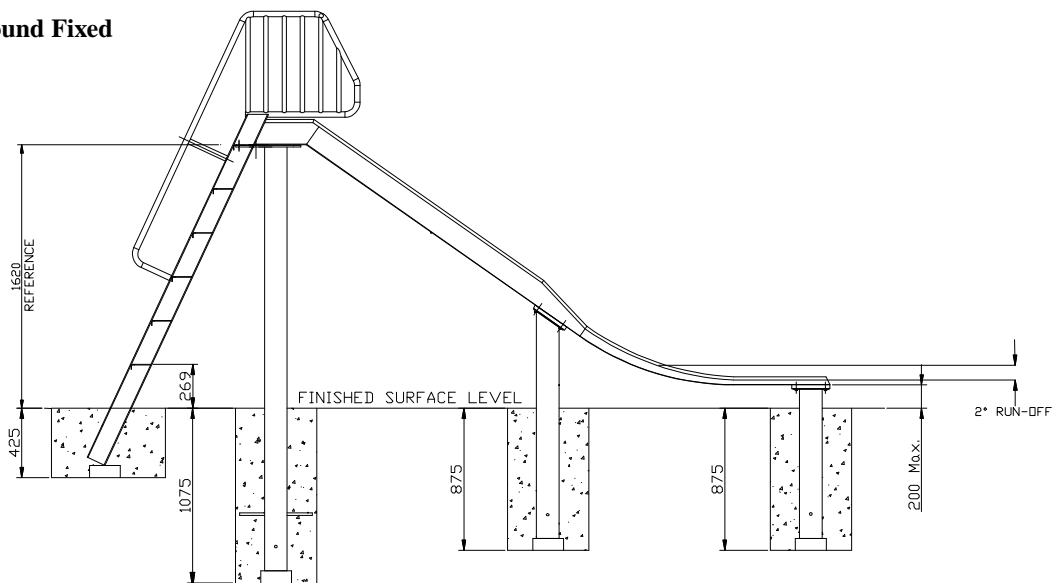

Bark Fixed

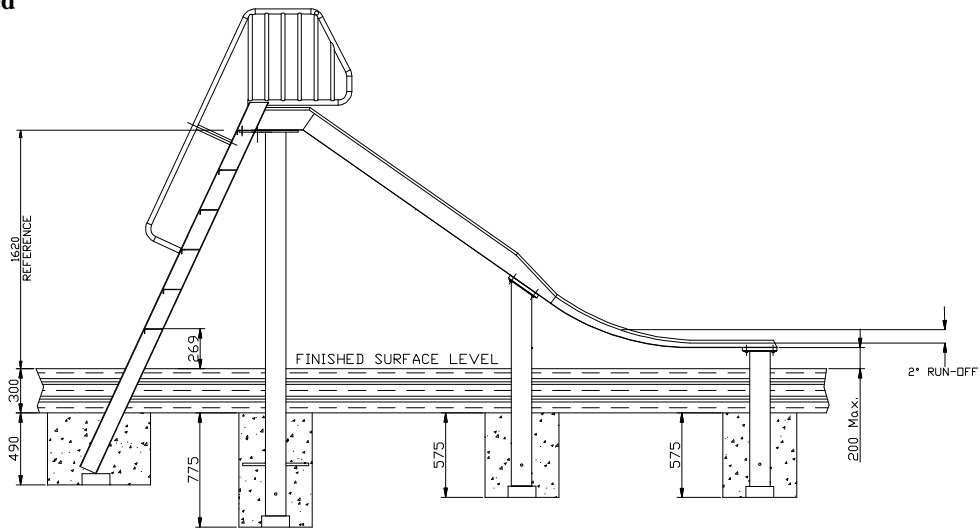

FIXING DETAILS

FIXING DETAILS FOR CHUTE

Fit Slide Chute to Support Tube plate with M10 x 30 Pentagon Button Head Screw, 10mm Fibre Washer, M10 Nyloc Nut and M10 Nut Cover.

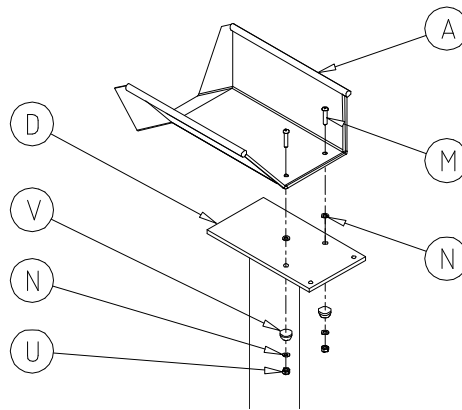

FIXING DETAIL FOR SLIDE CHUTE & STEP ASSY

Fit top step to support tube plate using M10 x 30 Pentagon Button Head Screw, 10mm Fibre Washer, M10 Nyloc Nut and M10 Nut Cover.

Ensure step assy is fitted centrally and square to the chute to reduce entrapments i.e. ensure the gaps either side are the same

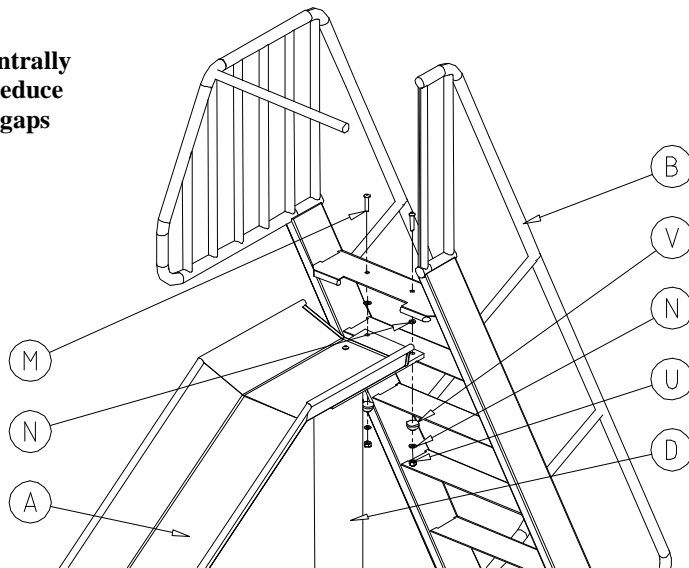

FIXING DETAIL FOR SLIDE CHUTE & SUPPORT TUBES

Fit slide chute to support tube using M12 x 25 Pentagon Button Head Screw and 12mm Fibre Washer.

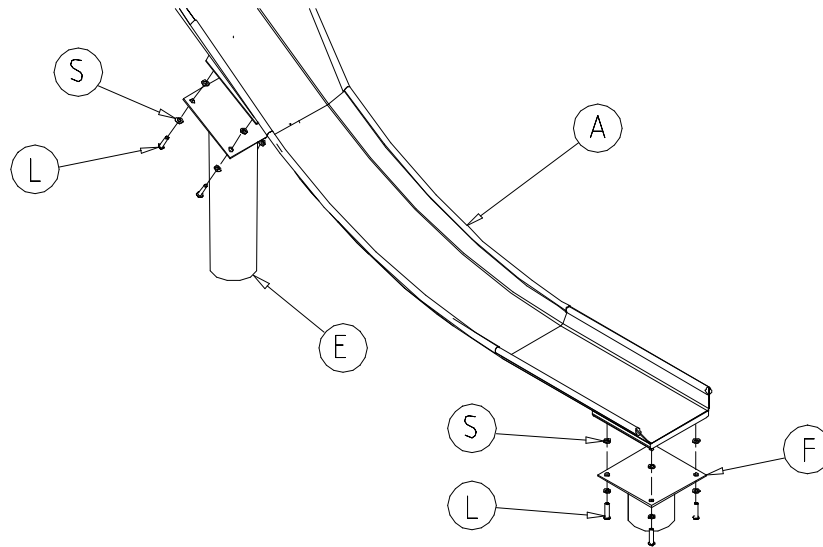

PARTS LIST

REF	QTY	DESCRIPTION	PART No
A	1	Slide Chute Assembly	5031-410
B	1	Medium Slide Ladder Assembly	5051-026
D	1	Support Tube—Medium Slide	4013-035
E	1	Support Tube—Middle	4013-037
F	1	Support Tube—Runout	4013-038
G	4	Spragging Iron	3030-009
L	8	M12 x 25 Pentagon Button Head Screw	2176-176
M	4	M10 x 30 Pentagon Button Head Screw	2176-127
N	8	10mm Fibre Washer	2571-012
S	16	12mm Fibre Washer	2571-013
U	4	M10 Nyloc Nut	2192-006
V	4	M10 Nut Cover	2613-014
For Bark Fixed Units Replace Item B with			
B*	1	Bark Fixed Medium Slide Ladder Assembly	5051-029

Note:-All spare parts are available from Wicksteed Leisure on request.

For maintenance instructions see separate sheet.

COMPILED:	APPROVED :	REV	NEW	1	2	3	4	5	6	7
P.GODFREY		ECN	1317	minor	1449	minor	minor	minor	minor	minor
DATE:	DATE:	SIG.	PG	SCJ	SB	SB	SB	TW	AB	PG
30/11/99		DATE.	30/11/99	21/03/01	08/08/03	09/03/04	23/11/05	25/08/06	28/03/07	14/8/15

